

ISFX160

Circulation Equipment



Inline Duct Fan manufactured for use in Class I, Division 2, groups B/C/D hazardous (classified) locations with an operating temperature code of T3C (320°F/160°C)

FEATURES:

- Certified by CSA (bearing the CSA mark) for compliance to applicable codes and standards
- Suitable for indoor and outdoor use
- Mounting bracket furnished for indoor or outdoor installation
- 115 volts AC, single phase, 60 Hz power requirements
- Spark resistant construction
- ½" NPT conduit connection for easy power wiring
- Can be used with or without circular duct
- Functions as supply or exhaust fan
- Limited stock available for shorter lead time



APPLICATIONS:

- Small control cabinets
- Lavatory ventilation
- Sewage treatment plants

END VIEW

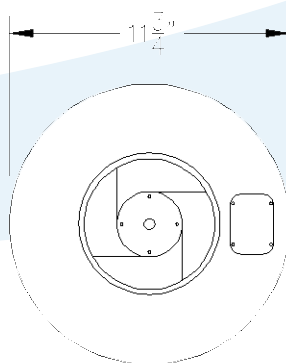

SIDE VIEW

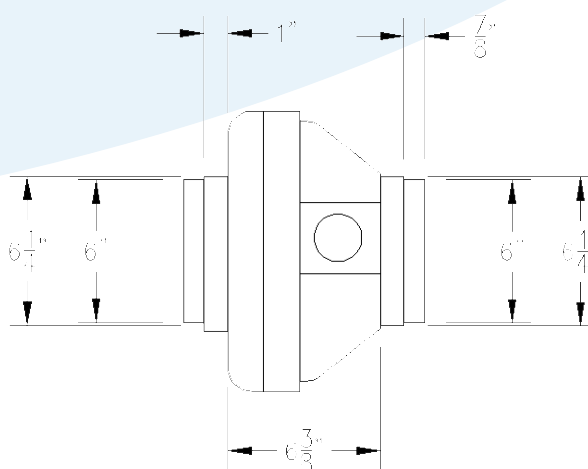

*Performance is based on ducted outlet.

ISFX160	Unit Weight (lbs)	Unit Weight (kg)	Duct Size	Volts - Phase	Rated Watts	Max Amps	RPM	* Air Flow (CFM) at Static Pressure (IN W.C.)
	20	9	6"	115-1	129	1.14	2750	0.0
								0.2
								0.4
								0.6
								0.8
								1.0
								1.5
								89